

MATRIX

TRAVEL TRAILERS OF EXTRAORDINARY STYLE AND LUXURY

LUXURY SERIES FLOOR PLANS

SPECIFICATIONS

Specifications are approximate and subject to change. Check the weight sticker in your unit for actual weights.

	220RB	246BH	258RB	282BH	284QB	290RL	333BH
Length	27'11"	30'4"	31'5"	32'0"	34'9"	34'4"	37'6"
Width	9'6"	9'6"	9'6"	9'6"	9'6"	9'6"	9'6"
Ext. Height	11'0"	11'0"	11'0"	11'0"	11'0"	11'6"	11'6"
Int. Height	8'0"	8'0"	8'0"	8'0"	8'0"	8'0"	8'0"
Dry Weight	5,685	5,903	5,957	6,251	6,737	7,117	8,300
Hitch Weight	620	610	740	780	980	920	1,160
Net Carry Cap.	1,935	1,707	2,042	1,657	1,262	2,603	1,908
Fresh Water	51	51	51	51	51	51	51
Grey Tank	72	72	72	72	72	36	36
Black Tank	36	36	36	36	36	36	36
Furnace	20,000	20,000	35,000	35,000	35,000	35,000	35,000
Water Htr.	6 Gal	6 Gal	6 Gal	6 Gal	6 Gal	6 Gal	6 Gal
LP Tank	2 X 20	2 X 20	2 X 20	2 X 20	2 X 20	2 X 20	2 X 20

BUILD TECH LAMINATED SIDEWALLS

Using processes perfected through years of innovation, our laminated sidewalls combine a light yet resilient welded square-tube aluminum frame and exterior fiberglass with structural, insulating, and decorative layers using advanced heat-resistant adhesives in a vacuum chamber where the layers are bonded into a remarkably light, incredibly strong unit.

- 1 Gleaming exterior fiberglass
- 2 AZDEL synthetic composite
- 3 Rigid closed-cell foam insulation
- 4 Welded square-tube aluminum skeleton frame
- 5 Structural plywood inner wall
- 6 Decorative easy-care vinyl wallcovering

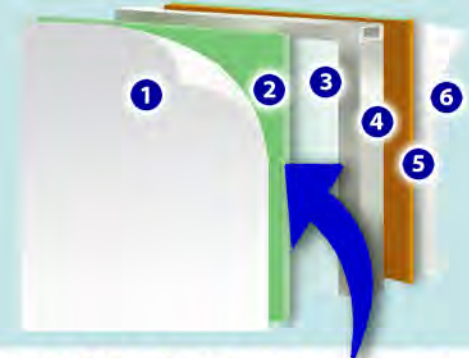

THE AZDEL ADVANTAGE

Key to Matrix vacuum-bonded sidewalls is a structural layer of AZDEL synthetic composite. AZDEL can't absorb moisture, so it won't rot or mildew, and can't delaminate. It insulates against extremes of temperature and noise, contains no formaldehyde, and weighs half as much as the wood it replaces.

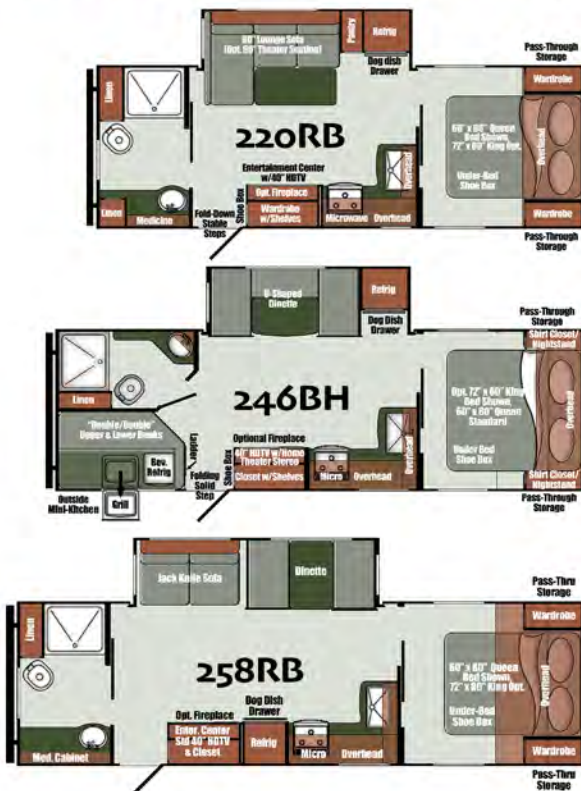

MATRIX

LUXURY SERIES STANDARD FEATURES

Interior

- 'Matador Frost' Ceiling Panels
- 'Plush Dunes' Wall Vinyl
- Cabinetry w/Solid Wood Stiles & Cabinet Doors
- Designer Window Treatments

Heating, Cooling, Electrical

- Cool, efficient Interior LED Lighting
- LED Motion Sensor Lighting in Pass-Through Storage Area
- Central Command Switch Panel w/Monitor
- Multiple USB Charging Ports
- LED Motion Sensor Entry Light
- Tech-Ready Features:
 - Wi-Fi Ready
 - Cable and Satellite Connections
 - Solar Panel Ready
 - Back-Up Camera Prep
- Dump Valve Light
- 35-Amp Converter w/Charger & LED Indicators
- 30 ft. Detachable 30 Amp Power Cord

Safety

- Safety Chains
- Break-Away Switch
- Wall Mount Fire Extinguisher
- Combo LP and CO Detector
- Smoke Detector
- Exterior LP Gas Hookup

Bath

- Foot Flush Toilet
- Vortex Bath Fan
- Medicine Cabinet with Mirror
- 30" x 36" Walk-In Shower w/Door (220RB, 246BH, 258RB, 282BH, 290RL)
- 24" x 26" Bathtub with Surround and Tub/Shower Doors (284QB)
- Neo-Angle Corner Shower (333BH)
- Skylight in Shower/Tub

Appliances

- Stainless Steel 3-Burner Range w/Oven & Glass Cover
- Stainless Steel Microwave Oven
- Stainless Steel Range Hood w/Light
- 12V 10.7 cu. ft. Stainless Steel Everchill Refrigerator/Freezer
- Prep for Outdoor Gas Grill

Windows and Doors

- Friction Hinge Entry Door(s)
- Black Radius Tinted Windows
- Radius Compartment Doors with Magnetic Catch Latches

Furnishings

- Designer Window Treatments
- Booth Dinette (258RB, 282BH, 284QB, 290RL, 333BH)
- U-Shaped Dinette (246BH)
- Tri-Fold Sofa (258RB, 282BH, 284QB, 290RL)
- L-Shaped Lounge w/Folding Table (220RB)
- Bunk Beds w/Poly Mattresses (246BH, 282BH, 284QB, 333BH)
- Kid's Dinette/Game Table (284QB, 333BH)
- 60" x 80" Queen Bed
- Designer Bedspread
- Under-Bed Shoe Storage

Exterior

- One-Piece Vinyl Roof
- Fiberglass Exterior Sidewalls w/AZDEL
- Easy-Lube Axles
- (2) 20 lb. LP Bottles w/Cover
- Gutter Rail & Rain Spouts at Roofline
- Radial Tires w/Aluminum Rims
- Outside Convenience/Snack Center (246BH, 282BH)
- Outside Kitchen (333BH)

POPULAR OPTIONS

- Free-Standing Table with 4 Chairs
- 2nd Air Conditioner (13,500 BTU, 50 Amp Service required)
- (4) Electric Stabilizer Jacks
- Electric Fireplace/Heater
- Theater Seating in place of Tri-Fold Sofa
- 8 cu. ft. 3-Way Refrigerator in place of 12V Everchill (6 cu. ft. in 220RB, 246BH, 290RL)
- Painted Front Cap

INCLUDED LUXURY ITEMS

Power Package (Incl.)

- Power Tongue Jack
- Power Awning w/LED Lighting
- Blue Tooth Stereo System w/Sound Bar
- Marine Grade Exterior LED Speakers
- 15,000 BTU Ducted Air Conditioning
- LED Exterior Clearance & Tail Lights
- 40" LED TV w/Interior & Exterior Mounting Brackets (N/A 284QB,333BH)
- 50" LED TV w/Interior & Exterior Mounting Brackets (284QB, 333BH)

Worry-Free Camping Package (Incl.)

- Fold-Down Solid-Step
- Fold-Away Safety Grab Handle
- Walk-On Roof w/Ladder
- Exterior Docking Station for Utility Hookups
- Gas/Electric DSI Water Heater
- Spare Tire with Carrier
- Black Tank Flush
- Fiberglass Front Cap w/LED Lights
- Front Diamond Plate Rock Guard
- Slam-Latch Cargo Doors; Magnetic Catches

Silver Lining Climate Package (Incl.)

- Heated/Enclosed Underbelly w/Dedicated Heat Duct
- Double-Wrapped Radius Roof & Floor
- 35,000 BTU Gas Furnace

Chef's Best Kitchen (Included)

- Industrial Stainless Steel Sink w/Cover
- Pull-Down Faucet w/Sprayer
- Easy-Clean Seamless Countertops
- Solid-Surface Kitchen Countertop
- Backsplash behind Range

EMPEROR OPTION

- 72" x 80" King Size Bed for Master Bedroom



THE MATRIX 3-YEAR WARRANTY

Our exclusive 3-year Limited Warranty gives you peace of mind by covering key structural components (floor, roof, side, front, and rear walls) of your new Matrix travel trailer. In addition, suppliers of other key components also provide enhanced coverage to Gulf Stream Coach customers.

Check the full written warranty for complete information.

For more information see your Gulf Stream Coach Dealer or visit www.gulfstreamcoach.com. Features, specifications, materials, and components are subject to change without further notice. Not responsible for typographical errors. Photos may show optional features.

© 2022 Gulf Stream Coach, Inc., Nappanee, IN, USA • MAT122022

Your Gulf Stream Coach Dealer:

QUALITY • VALUE • INNOVATION

505 S Oakland Avenue • Nappanee, IN • 46550
www.gulfstreamcoach.com

